

TT370-A1B1

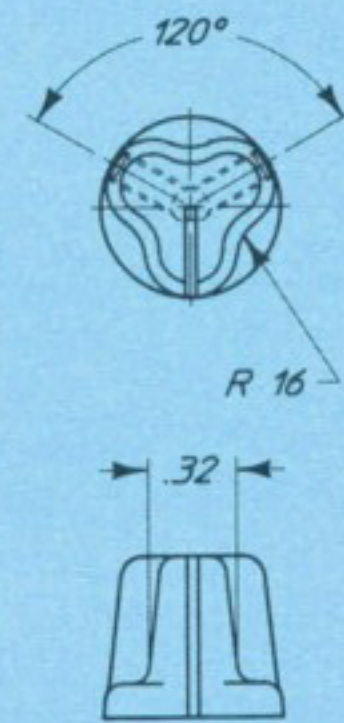

TT370-A1G1



TT 371

TT 370

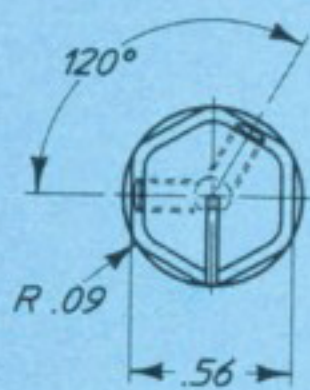

TT 372



TT 373

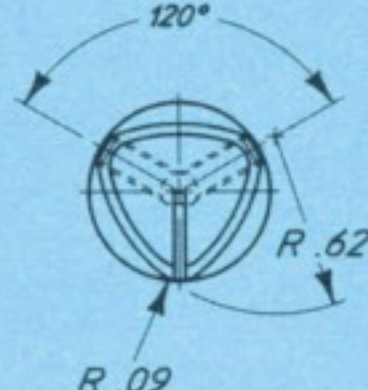

TT 374

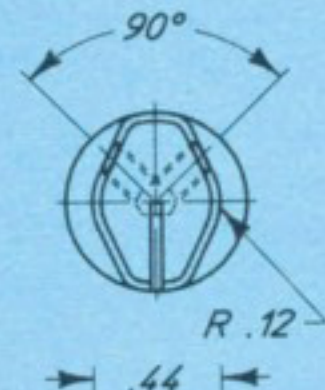

TT 375

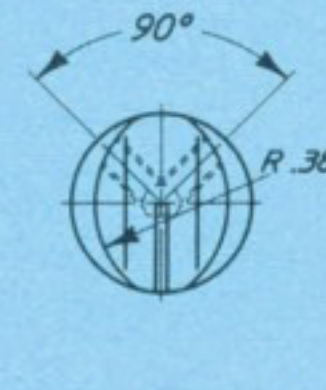

TT 376

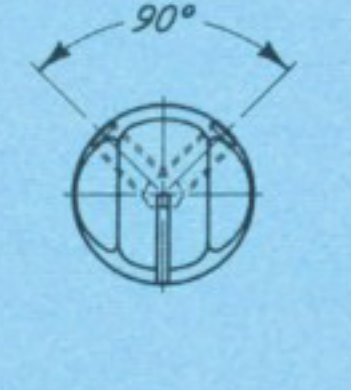

TT 377



TT 370



TT 371



TT 372



TT 373



TT 374



TT 375



TT 376



TT 377

PART NO. EXAMPLE: **TT 370 - A 1 B 1**

SERIES	KNOB NO.		MARKING STYLE	MARKING TYPE	COLOR	A - SHAFT HOLE ±.001	
	370	374				ROUND	FLAT
TT	370	374	A	1	G	1	.128
	371	375	AV	2	B		.108
	372	376	E				
	373	377	EV			*3	.128
			N				NONE

(Omit marking type code from part no. of no-marking knobs.)

KNOB NO.	BRIGHTNESS RATIO ±25%	SET SCREWS	MAX. WT. OZ.
		SHAFT HOLE SIZE	
		1/8	
370	†	MS51021-101	0.14
371	†	MS51021-102	0.14
372	†	MS51021-102	0.16
373	†	MS51021-101	0.14
374	†	MS51021-102	0.12
375	†	MS51021-101	0.14
376	†	MS51021-101	0.12
377	†	MS51021-102	0.14

SPECIFICATIONS:

- Material: Thermoplastic molding compound, clear for transilluminated knobs and colored for non-illuminated knobs. Insert is brass per QQ-B-626 (or equivalent).
- Shaft hole diameters conform to MS33743 (except for 3/16 size) to accommodate control shaft diameters conforming to MS33742.
- Finish: Knob, black color no. 37038; gray color no. 36231 per Federal Standard 595. White color no. 37875 per Federal Standard 595 except reflectance may be reduced to 50% minimum. All white markings on gray knobs are surrounded by a black border as shown. Insert is nickel plated per QQ-N-290.

- The daylight contrast of our knobs meets a value of 9 minimum. Contrast (C) is defined as:

$$C = \frac{B_2 - B_1}{B_1}$$

Where B_1 is the average brightness of the black border or background and B_2 is the average brightness of the marking.

- The brightness ratio shown on our drawings is the ratio of average brightness of the illuminated marking on the knob to the average brightness of a standard light source which simulates the knob lighting aperture of an edge lighted panel and is expressed as a decimal. This information may be used by the designer to establish the brightness of the knob lighting apertures of the edge lighted panel.

† Brightness ratios are omitted from this catalog due to lack of complete data on all listed dash numbers. Document control drawings will include the brightness ratios, as required.

- Brightness ratio does not include markings within .25 radius of center of knob. Brightness values do not apply to non-illuminated knobs.
- Unless otherwise specified, tolerance is ± .02 inch for two place decimal dimensions ± .010 inch for three place decimal dimensions and ±2° for angles.
- Knobs with round shaft holes are not recommended for aircraft applications.